

## Chain Slings and Fittings

### 8015 - G80 Clevis Hook with Safety Latch

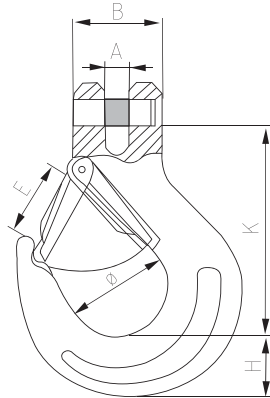

#### Description:

- For use with Grade 80 alloy steel chain
- Suitable for overhead lifting application
- Size, CE, WLL, Traceability code & GRIPTON or GPT embossed

Standard:	EN 1677
Material:	Alloy steel
Factor of safety:	4 to 1
Construction:	Quenched & tempered
Proof load:	2 times of working load limit
Finish:	Powder coated

Clevis Hook with Safety Latch								
Part No.	WLL/T	A (mm)	B (mm)	Ø (mm)	H (mm)	K (mm)	E (mm)	Weight (Kg)
8015.00.8	2	9.5	37	37	32.5	85.5	29	0.52
8015.0010	3.15	13	49	46	35	104	39	1.05
8015.0013	5.3	16.5	56.5	56	42.5	128	47	2.00
8015.0016	8	21.5	70.5	60	54	150	55	3.70
8015.0020	12.5	24	77	79	58	180	61	6.00
8015.0022	15	27	91	101	62	213	72	10.40